

Special Color LED Light Strip

30 x SMD5050

LSB3XXS

Descriptions:

- Waterproof level : IP65
- Low power consumption
- Voltage available in DC12V
- LED Type: 5050 SMD LED
- With a self-adhesive back

Application:

- Auto lighting
- Channel letter signs
- Indirect accent décor light
- Large area back lighting
- Under counter light
- Decorate building's contour
- Substitute neon light

Photo



Circuit Diagram

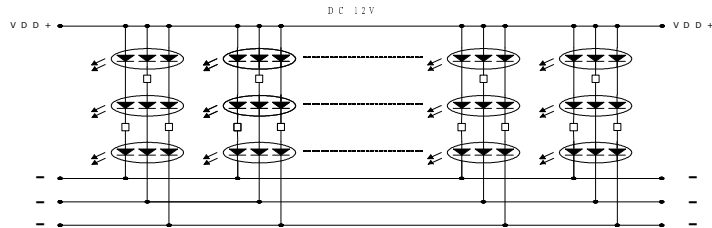

Outline Dimension

Unit: mm

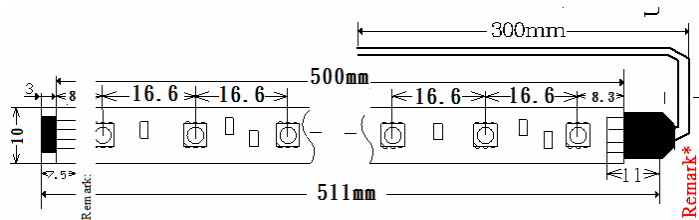

Typical Performance (Ta=25°C)

| Items | Symbol | Min. | Typ. | Max. | Units |
|-----------------------|--------|------|------|------|-------|
| LED Module Power | Pm | | 7.2 | 12.6 | w |
| Input Voltage(DC) | Vi | | 12 | 14 | V |
| Input Current | If | | 0.6 | 0.9 | A |
| Beam Pattern | BP | | 120 | | Deg |
| Operating Temperature | Topr | -30 | - | 85 | °C |
| Storage Temperature | Tstg | -40 | - | 100 | °C |
| LED Quantity | QTY | - | 30 | - | PCS |
| Total Length | Lmod. | - | 500 | - | mm |

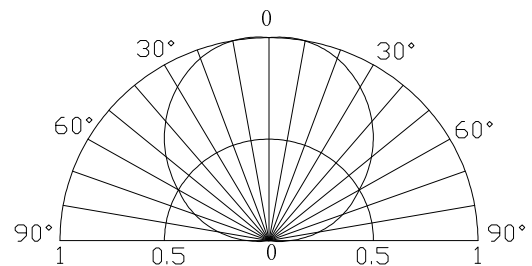

Device Selection Guide

| Module No. | Color | Dom. Wavelength (Typ.) | Flux*/Per LED (Typ.) |
|------------|-------------------|------------------------|----------------------|
| LSB3B6S | Ice Blue | X=0.19;Y=0.29 | 21 lm |
| LSB3G7S | Fluorescent Green | X=0.35;Y=0.50 | 21 lm |
| LSB3K6S | Sakura | X=0.25;Y=0.14 | 11 lm |
| LSB3Y6S | Gold | 590~597nm | 6 lm |