

**■Features**

- High Luminous LEDs
- 5mm Standard Directivity
- Long Lifetime Operation
- UV Resistant Epoxy
- Water Clear Type

**■Applications**

- Automotive Dashboard Lighting
- Small Area Illuminations
- Back Lighting
- Other Lighting

**■Outline Dimension**

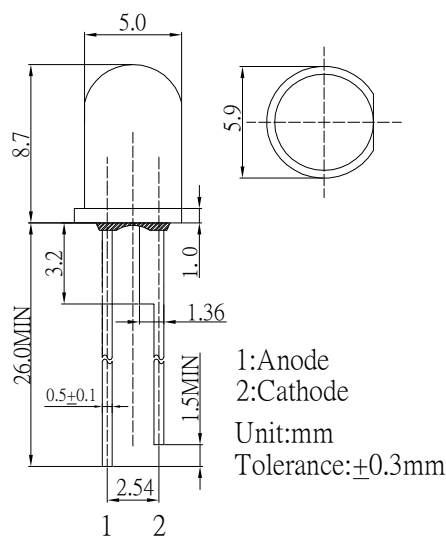

**■Absolute Maximum Rating (Ta=25°C)**

Item	Symbol	Value	Unit
DC Forward Current	$I_F$	50	mA
Pulse Forward Current#	$I_{FP}$	120	mA
Reverse Voltage	$V_R$	5	V
Power Dissipation	$P_D$	180	mW
Operating Temperature	$T_{opr}$	-30 ~ +85	°C
Storage Temperature	$T_{stg}$	-40 ~ +100	°C
Lead Soldering Temperature	$T_{sol}$	260°C/5sec	-

#Pulse width Max.10ms , Duty ratio max 1/10

**■Directivity**

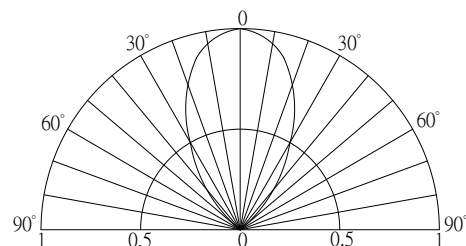

**■Electrical -Optical Characteristics (Ta=25°C)**

Item	Symbol	Condition	Min.	Typ.	Max.	Unit
DC Forward Voltage*1	$V_F$	$I_F=50mA$	2.8	3.1	3.6	V
DC Reverse Current	$I_R$	$V_R=5V$	-	-	10	$\mu A$
Luminous Intensity*2	$I_v$	$I_F=50mA$	14400	18000	-	mcd
Color Temperature*3	CCT	$I_F=50mA$	-	3000	-	K
Chromaticity Coordinates*4	x	$I_F=50mA$	-	0.45	-	
	y	$I_F=50mA$	-	0.41	-	
50% Power Angle	$2\theta_{1/2}$	$I_F=50mA$	-	60	-	deg

\*1 Tolerance of measurements of forward voltage is  $\pm 0.1V$

\*2 Tolerance of measurements of luminous intensity is  $\pm 15\%$

\*3 Tolerance of measurements of color temperature is  $\pm 10\%$

\*4 Tolerance of measurements of chromaticity coordinates is  $\pm 10\%$

**InGaN LED**

**TYPICAL ELECTRICAL/OPTICAL CHARACTERISTIC CURVES**

